

LETTER PLATES

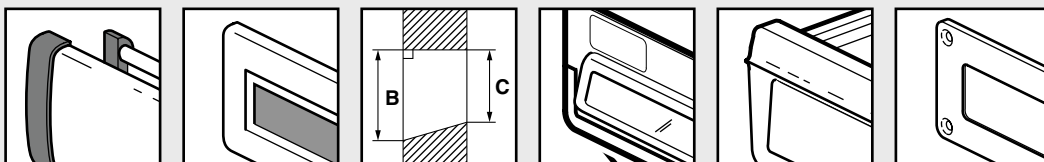
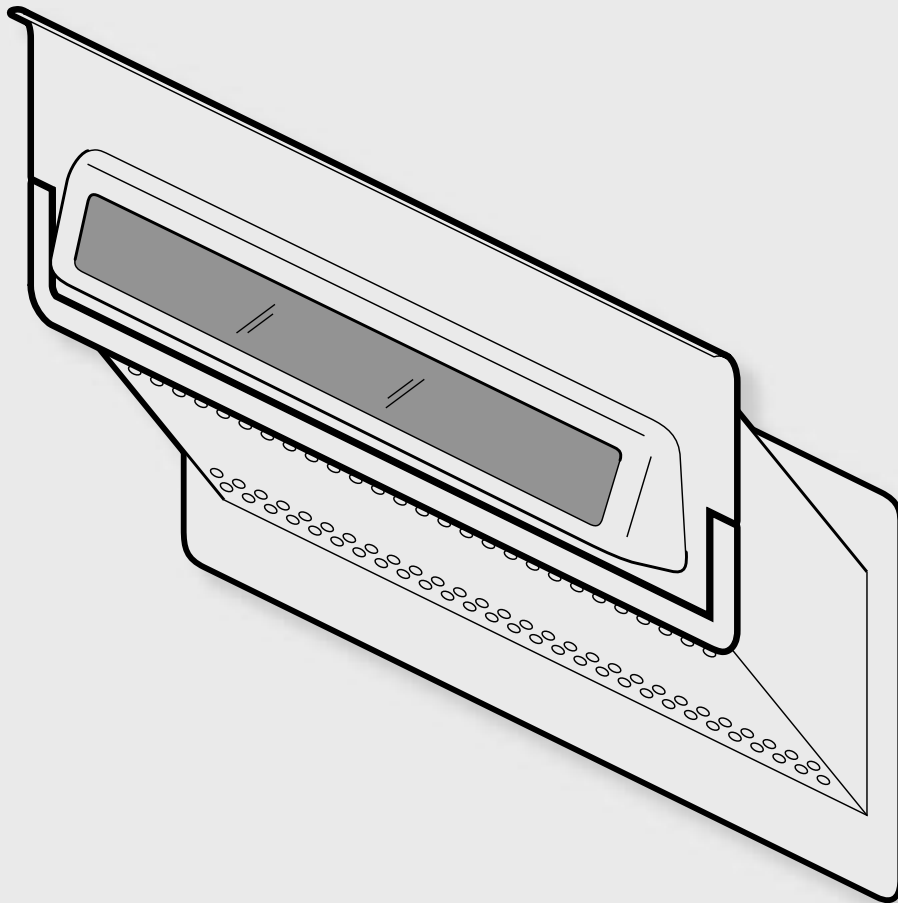

TERMS

Terms of payment New customer: payment in advance
Established customer: 30 days net

Interest on overdue payment 18% per commenced month

Standard pack Illustrated in this brochure

Packaging Charged at cost price

Mode of transportation Menova will assess and select the mode of transportation unless the customer has specifically requested another method

Terms of delivery Free Carrier Eskilstuna, Sweden.

Guarantee All products manufactured by Menova have a three year guarantee, which means that products are replaced free of charge if they have manufacture or material defects.

Menova is not responsible for any incidental costs arising in connection with the replacement of defective products. These are to be returned for inspection.

The guarantee does not cover products that have been exposed to violence, incorrect installation or that have had their functionality altered.

Miscellaneous A handling charge of EUR 10 applies for orders less than EUR 50 net.

No refund given for goods with opened packaging.

Letter plate 2003

FOR RAINPROOF INTERIOR AND EXTERIOR DOORS.

Door thickness range:

Adjustable

- This letter plate is suitable for both interior and exterior doors.
- Easy to cut out and install.
- This letter plate is manufactured in plastic and the surface finishes available are anodized aluminum or anodized gold.
- The elegant design makes this letter plate suitable for more exclusive settings.
- The screws are hidden and the materials are combined in a new and modern way.
- Can be adjusted for different door thickness.

Anodized
aluminum



Anodized
gold

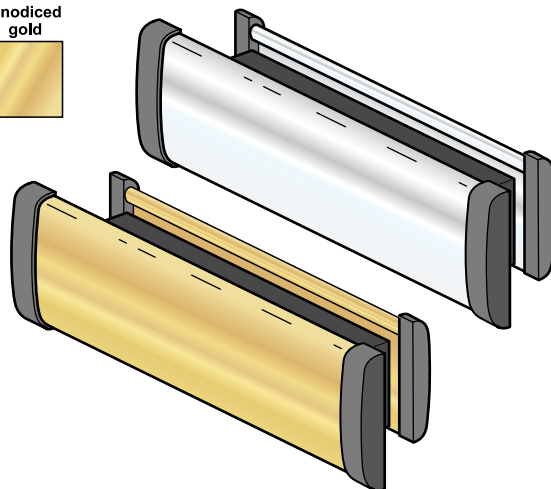

Part number

| | | |
|----------------|-------------------|---------------|
| Surface finish | anodiced alumnium | anodiced gold |
| Part no. | 4250 | 4251 |

Cut out drawing

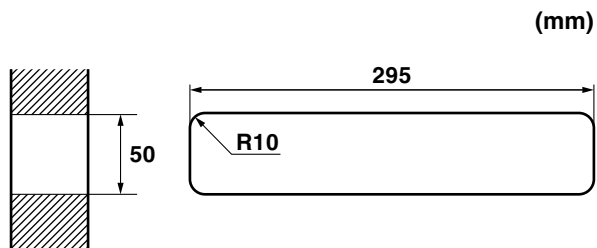

Measurements

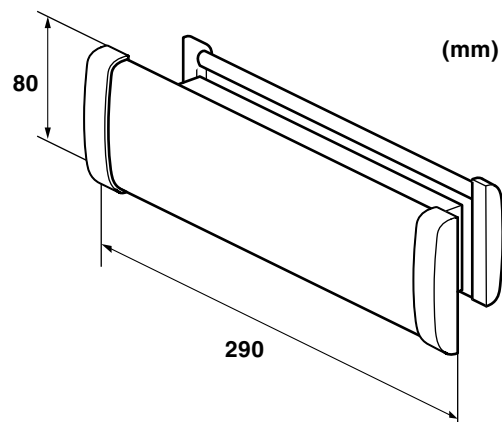

MENOVA

P.O. Box 92, SE-631 02 Eskilstuna, SWEDEN

Int. Tel: +46 16 13 75 05, Int. Fax: +46 16 51 18 03

E-mail: mail@menova.se

MENOVA
www.menova.se

Letter plate 4ESS

FOR INTERIOR DOORS

Door thickness range:
40–84 mm

Nickel plated



Gold plated



- 4 ESS is a letter plate for interior doors approved by Boverket (standard approval certificate no. 4936/91). The manufacturing process is under supervision of the Swedish research laboratory.
- 4 ESS is a letter plate made of steel for wooden doors between 40–85 mm and for steel doors between 45–85 mm.
- The letter plate is delivered with fire protection plate, back plate and securing plate.
- 4 ESS fulfils both fire resisting class (E130) and noise resisting class (35 db) according to Swedish standard.
- The surface finishes available are nickel plated, gold epoxy or gold plated.
- The back plate can be delivered with interdens (fire swelling) or velour.

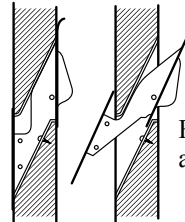
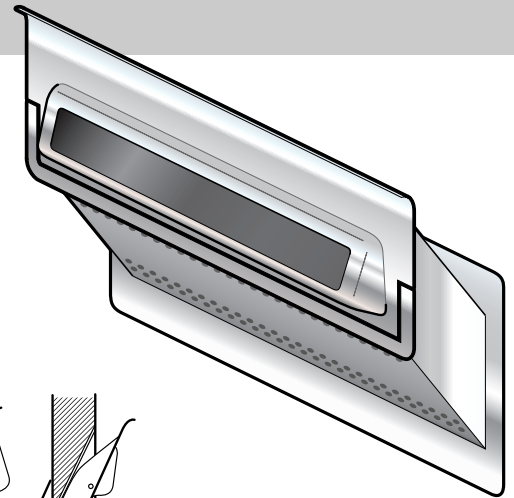

Front and back plate are connected.

Part number

| Door thickness (mm) | 40-44 | | 45-49 | | 50-54 | |
|---------------------|-------------|-------------|-------------|-------------|-------------|-------------|
| Surface finish | NP | GP | NP | GP | NP | GP |
| Part no. | 4640 | 4684 | 4645 | 4685 | 4650 | 4686 |

| Door thickness (mm) | 55-59 | | 60-64 | | 65-69 | 70-74 | 75-79 | 80-84 |
|---------------------|-------------|-------------|-------------|-------------|-------------|-------------|-------------|-------------|
| Surface finish | NP | GP | NP | GP | NP | NP | NP | NP |
| Part no. | 4655 | 4687 | 4660 | 4688 | 4665 | 4670 | 4675 | 4680 |

NP= Nickel plated, GP = Gold plated

Cut out drawing

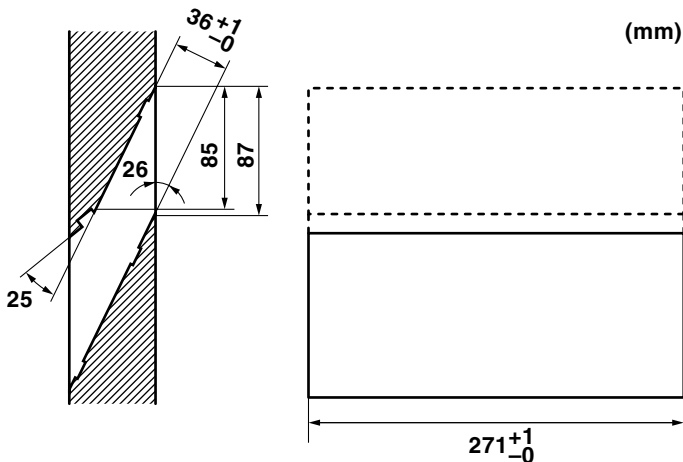

Measurements

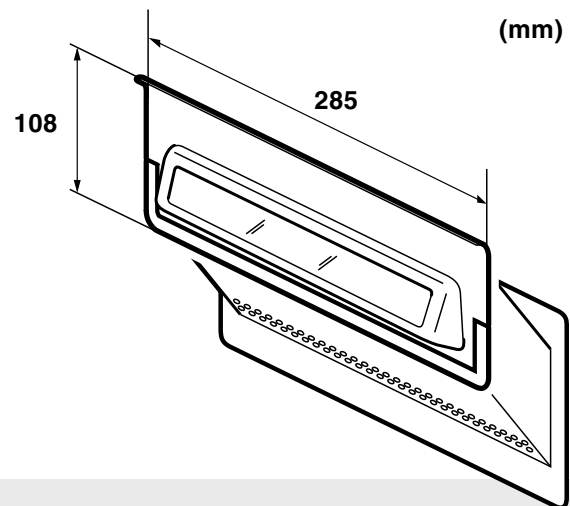

Letter plate no. 11 and 11P

FOR EXTERIOR DOORS

Door thickness range:
40–75 mm

Nickel
plated



Fogged
brass



- The upper edge of the letter plate is designed with a drip edge that prevents water leakage.
- The letter plate is manufactured in die-cast brass with adjustable fire protection plate in galvanised iron sheet.
- Delivered with screws and back plate. Note that the back plate is not for sale separately.
- The surface finishes available are nickel-plated and fogged brass.
- There is a sealing device and a sound-reducing strip of soft rubber between the back plate and the door leaf.
- Available either with front plate or letter bar.

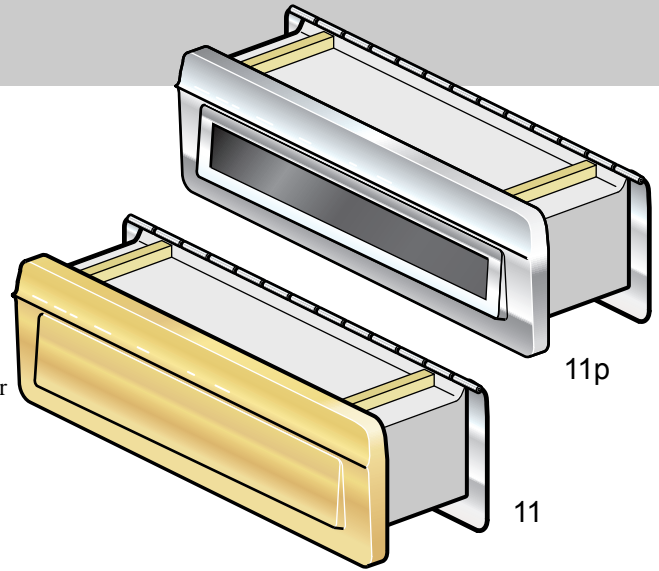

Part number

| Without letter bar | | | | |
|--------------------|-------------|-------------|-------------|-------------|
| Door thickness | 40-59 | | 60-75 | |
| Surface finish | NP | Fogged | NP | Fogged |
| Part no. | 4381 | 4383 | 4382 | 4384 |

| With letter bar | | | | |
|-----------------|-------------|-------------|-------------|-------------|
| Door thickness | 40-59 | | 60-75 | |
| Surface finish | NP | Fogged | NP | Fogged |
| Part no. | 4391 | 4393 | 4392 | 4394 |

NP=Nickel plated, Fogged=Fogged brass

Cut out drawing

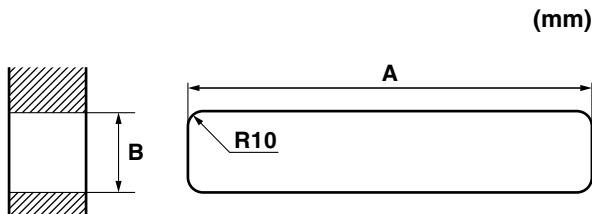

| Part no. | A | B |
|-----------|-----|----|
| 4381-4386 | 275 | 78 |
| 4391-4396 | 275 | 78 |

Measurements

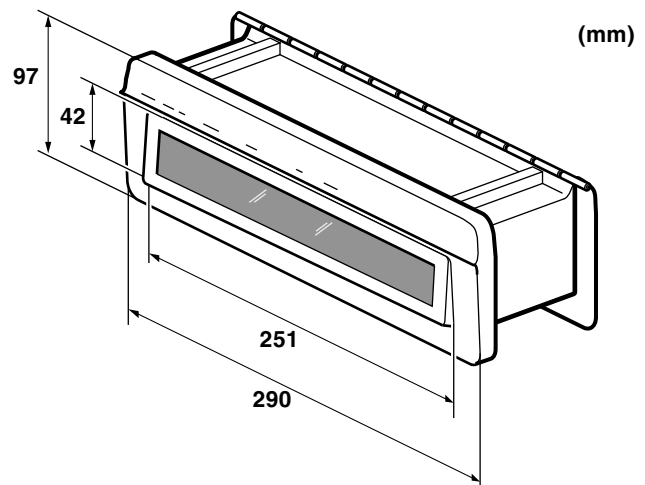

Letter plate 4231 and 4241

FOR EXTERIOR AND RAINPROOF DOORS

Door thickness range:

-60 mm

Stainless
steel



- This letter plate is adjusted for rainproof exterior doors.
- The letter plate is easily managed and installed.
- The letter plate is delivered without back plate. However back plates can be purchased separately.

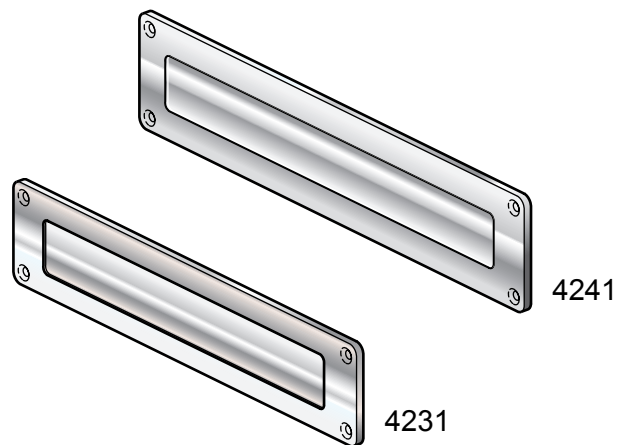

Part number

| | | |
|----------------|-----------------|-----------------|
| Height (mm) | 70 | 90 |
| Width (mm) | 275 | 320 |
| Surface finish | Stainless steel | Stainless steel |
| Part no. | 4231 | 4241 |

Cut out drawing

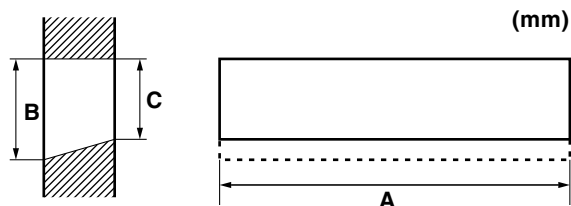

| Part no. | A | B | C |
|----------|-----|----|----|
| 4231 | 245 | 65 | 50 |
| 4241 | 275 | 75 | 60 |

Measurements

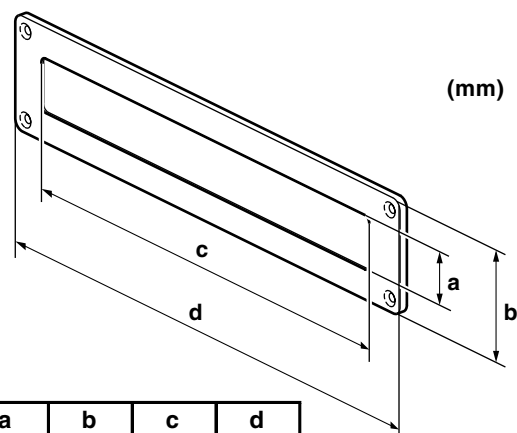

| Part no. | a | b | c | d |
|----------|----|----|-----|-----|
| 4231 | 35 | 70 | 230 | 275 |
| 4241 | 45 | 90 | 260 | 320 |

MENOVA

P.O. Box 92, SE-631 02 Eskilstuna, SWEDEN
 Int. Tel: +46 16 13 75 05, Int. Fax: +46 16 51 18 03
 E-mail: mail@menova.se

MENOVA
 www.menova.se

Letter plate 4308

FOR EXTERIOR AND RAINPROOF DOORS

Door thickness range:

-60 mm

- This letter plate is adjusted for exterior rainproof doors.
- The construction of the letter plate counteracts penetration of water. The plate can be opened upwards and has a drip edge which helps to prevent water from entering.
- The letter plate is available in nickel plated brass surface, but can if requested also be delivered in fogged brass.
- Adjusted back plates are available for purchase.

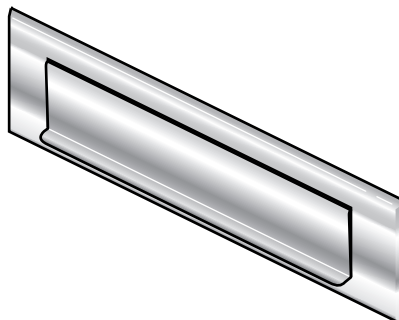

MENOVA

- Complete series of letter plates for both interior and exterior doors.
- Installation instructions for all products.
- Spare parts are available for all letter plates.

Part number

| | |
|----------------|---------------|
| Surface finish | Nickel plated |
| Part no. | 4308 |

Cut out drawing

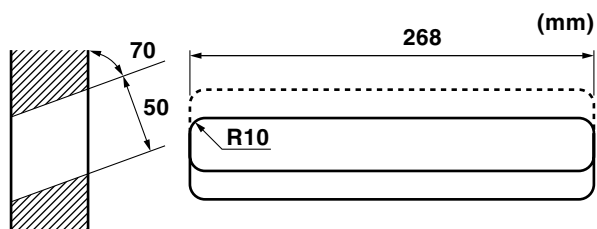

Measurements

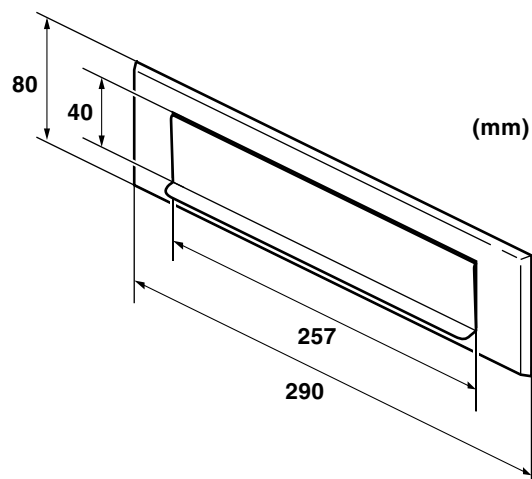

Letter plate 4302 and 4312

FOR INTERIOR DOORS

Door thickness range:

-60 mm

Nickel
plated



- This letter plate is easy and adjusted for interior doors.
- The letter plate is available in nickel plated brass.
- The letter plate is delivered with front plate. Back plate is also available for purchase.
- The letter plate is easy to install and is not adjusted for any special door thickness.

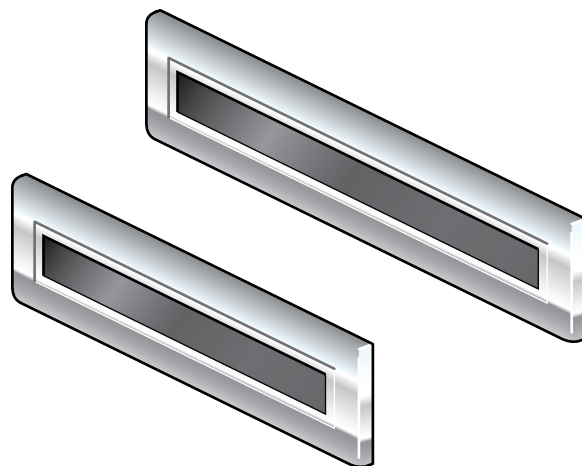

Part number

| | | |
|----------------|---------------|---------------|
| Width (mm) | 235 | 275 |
| Surface finish | Nickel plated | Nickel plated |
| Part no. | 4302 | 4312 |

| | | |
|---------------------|------|------|
| Back plate part no. | 4303 | 4313 |
|---------------------|------|------|

Cut out drawing

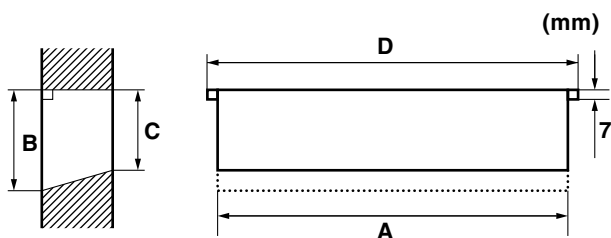

| Part no. | A | B | C | D |
|----------|-----|----|----|-----|
| 4302 | 220 | 75 | 60 | 240 |
| 4312 | 262 | 75 | 60 | 280 |

Measurements

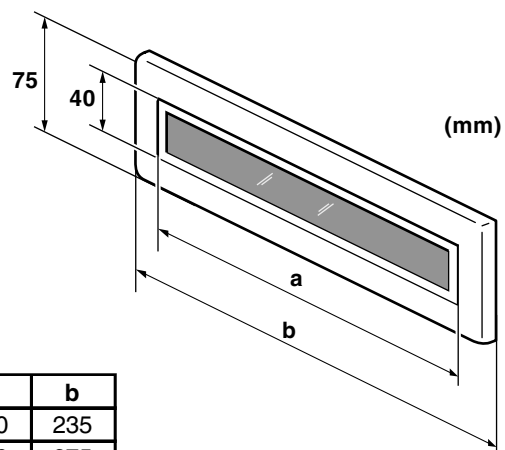

| Part no. | a | b |
|----------|-----|-----|
| 4302 | 200 | 235 |
| 4312 | 240 | 275 |

MENOVA

P.O. Box 92, SE-631 02 Eskilstuna, SWEDEN
 Int. Tel: +46 16 13 75 05, Int. Fax: +46 16 51 18 03
 E-mail: mail@menova.se

MENOVA
 www.menova.se

Letter plate 4371 and 4373

FOR INTERIOR DOORS

Door thickness range:

-60 mm

Nickel
plated



- This letter plate is adjusted for interior doors.
- Available in nickel plated brass.
- Easy to install and is not adjusted for any special door thickness.
- A back plate adjusted for this letter plate is also available for purchase.

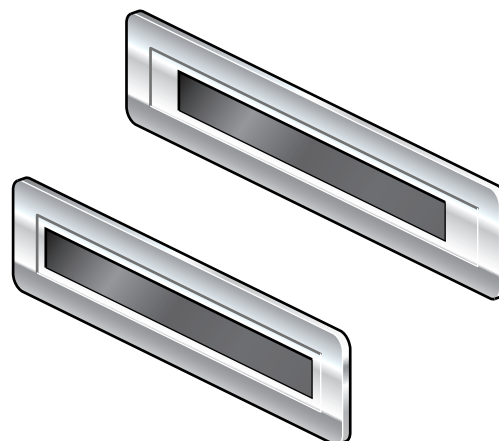

Part number

| | | |
|-----------------|---------------|---------------|
| Height (mm) | 85 | 80 |
| Width (mm) | 240 | 270 |
| Surface finish | Nickel plated | Nickel plated |
| Part no. | 4371 | 4373 |

| | | |
|---------------------|------|------|
| Back plate part no. | 4303 | 4313 |
|---------------------|------|------|

Cut out drawing

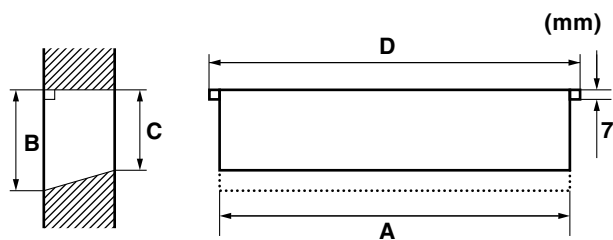

| Part no. | A | B | C | D |
|----------|-----|----|----|-----|
| 4371 | 220 | 70 | 60 | 240 |
| 4373 | 242 | 70 | 60 | 280 |

Measurements

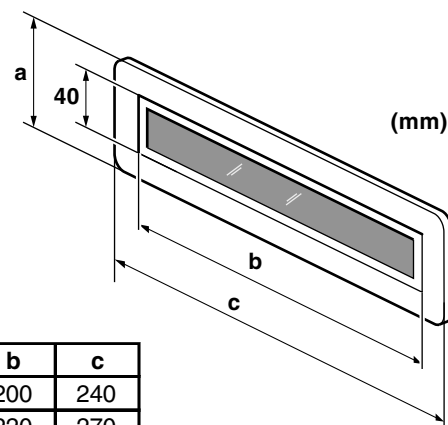

| Part no. | a | b | c |
|----------|----|-----|-----|
| 4371 | 85 | 200 | 240 |
| 4373 | 80 | 220 | 270 |

MENOVA

P.O. Box 92, SE-631 02 Eskilstuna, SWEDEN
 Int. Tel: +46 16 13 75 05, Int. Fax: +46 16 51 18 03
 E-mail: mail@menova.se

MENOVA
 www.menova.se

ACCESSORIES

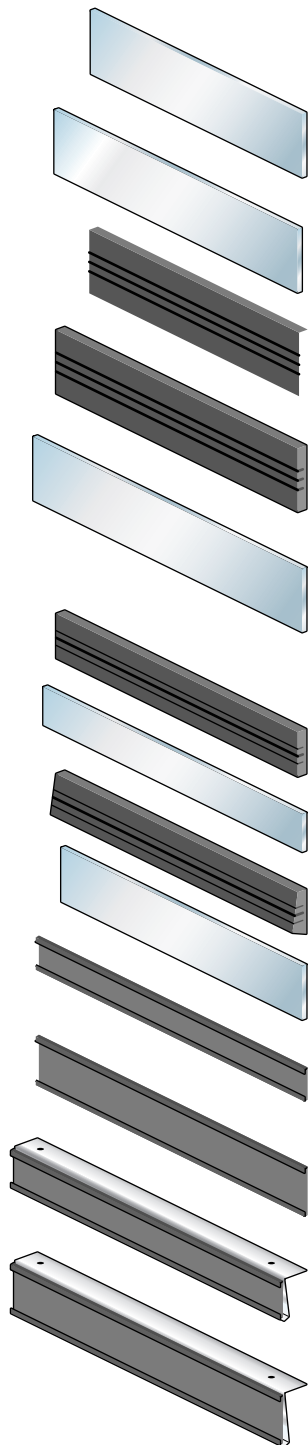

| Part. No. | Description |
|-----------|----------------------------------------------------------------------|
| 4202 | Glass no. 2, 7001 204x42x2 mm |
| 4203 | Glass 7003 225x42x2 mm |
| 4304 | Plate no. 2, 7001 7003 203x42x9 mm |
| 4314 | Plate arrow no. 12 224x42x9 mm |
| 4315 | Glass no. 12 242x42x2 mm |
| 4388 | Screws 11P, 35 mm |
| 4389 | Screws 11P, 55 mm |
| 4398 | Plate 11P |
| 4399 | Glass 11P |
| 4904 | Plate 4ESS |
| 4905 | Glass 4ESS |
| 4963 | Letter bar 13 mm ribbon marker Suitable for all letter plates |
| 4964 | Letter bar 19 mm marker ribbon Suitable for all letter plates |
| 4965 | Steel plate with 13 mm marker ribbon, For letter plates 4640–4680 |
| 4966 | Steel plate with 19 mm marker ribbon For letter plates 4640–4680 |



For more information of MENOVA quality products, please contact us.

MENOVA

P.O. Box 92, SE-631 02 Eskilstuna, SWEDEN

Int. Tel: +46 16 13 75 05,

Int. Fax: +46 16 51 18 03

E-mail: mail@menova.se

www.menova.se

